

CASE STUDY : BOTTOMLINE TECHNOLOGIES THEALE BERKSHIRE



Bottomline Technologies project in Theale Berkshire, was a 2 storey CAT B interior fit-out consisting of different styled offices and meeting rooms, breakout areas, client facing areas, new data, security, AV installation, new lift, external and internal glazing, new internal staircase with various types of finishes to walls, floors and ceilings.

Profixed were awarded the design, supply and installation of the partitioning, glazed partitions, suspended and feature ceilings, doors, frames, joinery, tea-points and all associated works.



Main Contractor

Morgan Lovell



"Profixed performed really well on this project. Karl was the star on site and always had control of all operatives who arrived, it made the job run incredibly smooth. Steve was also very helpful and had everything in hand. There were delays with some other trades which pushed back Profixed progress, however increasing resources and working long hours was not an issue and this pulled us out of a negative situation. Brilliant Project!" **Morgan Lovell, Trade Assessor**

Morgan Lovell
Inspiring office transformation

SKArating®

Completion

January 2020



Approx. Sq. ft.

60,000

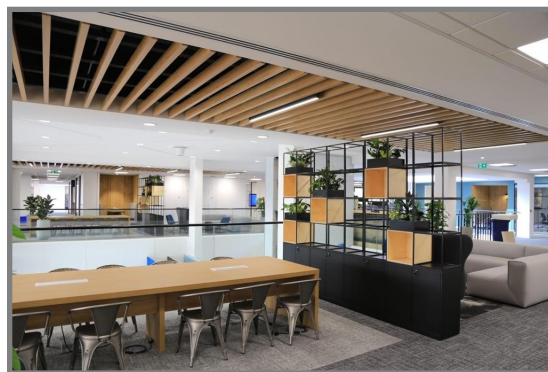

Site Safety Audit—2 September 2019

"During my inspection I was pleased to observe good housekeeping standards and full PPE compliance being executed by the Profixed team."

Site Safety Audit—8 October 2019

"All mandatory safety checklists have been completed every 7 days. All Profixed electricals have recently undergone inspection and testing."

Nicholas Proctor, Principle Consultant | Nicholas James Health & Safety Solutions Limited

SKA Rated Project

Gold



CAT B

Interior Fit Out

